

**NEW
Lease
Pricing**



FEATURES:

- 3,791 Square Feet
- 4-5 parking spaces per 1,000 Sq. Ft.
- 10 private offices
- Zoned HVAC
- Rear access
- Cat 5 wired
- Includes phone system with voicemail
- Conference room, break room, computer room, & storage
- Make ready and TI Allowance available
- **Lease Rate: \$9.00 psf NNN**

AERIAL VIEW



VICINITY MAP

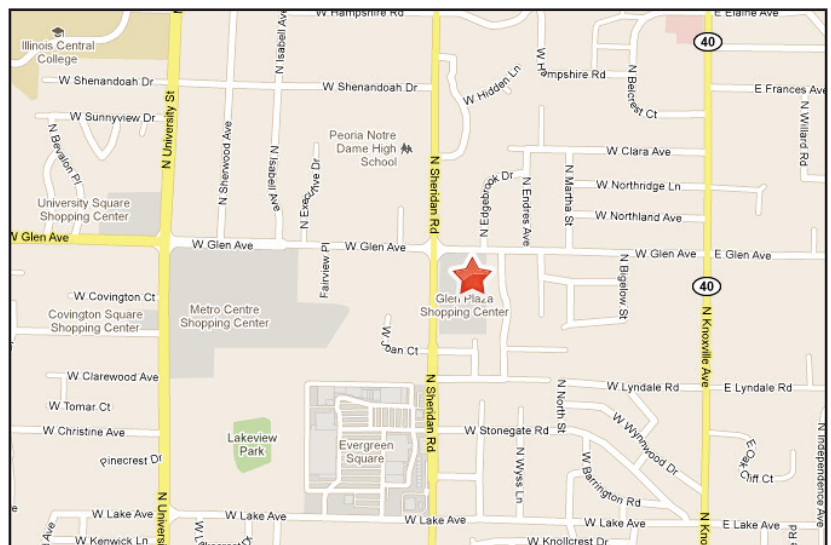

CONTACT:

Daniel J. Maloof

dan@maloofcom.com

p. 309 693.3000

f. 309 693.3336

Maloof Commercial Real Estate Company

2411 W. Cornerstone Court, Peoria, Illinois 61614

maloofcommercial.com

FLOOR PLAN

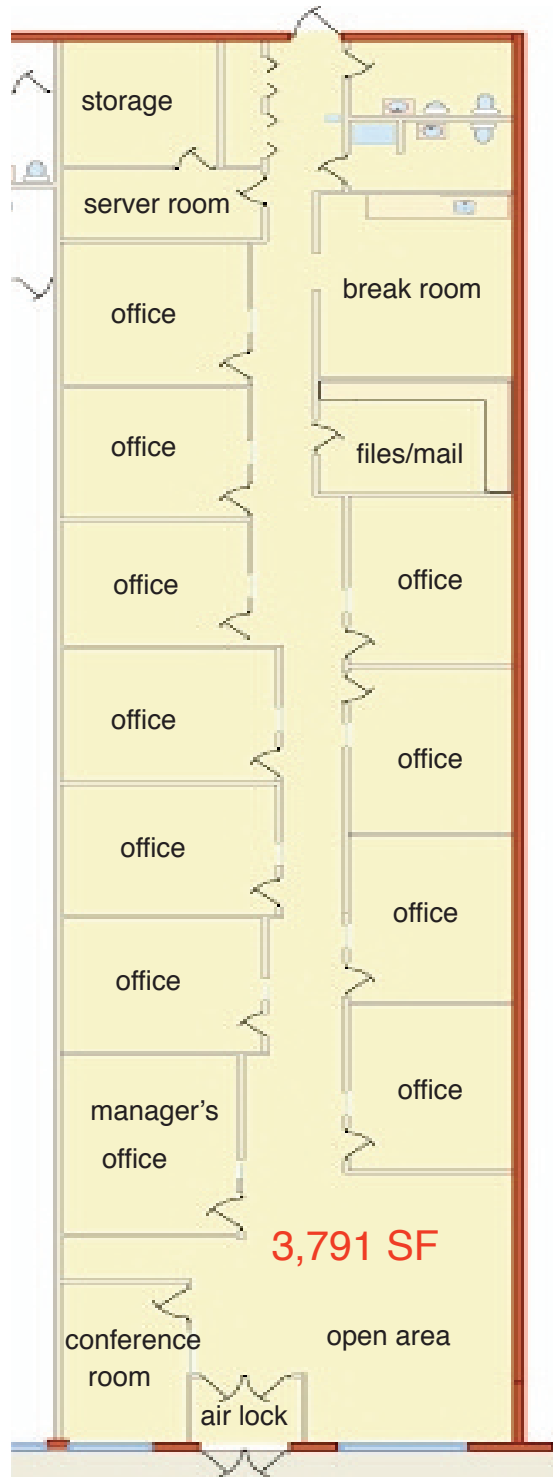

INTERIOR PICTURES

